

CUBEWORK®



485 N Jimmy Doolittle Rd.
Salt Lake City, UT 84116

 **(800) 338.6369**

 info@cubework.com

 www.cubework.com

 **LEARN
MORE**

KEY DISTANCE



BUILDING SPECS:

Building size: 148,263 SF

Warehouse size: 300-50,000 SF

Private office available: 300-3,030 SF

Floor: Reinforced Concrete

Column spacing: 54' x 53'

Clear height: 32'

Drive-in Bays: 4

Exterior Dock Doors: 29

Standard Parking Spaces: 198



3.7 mi

Salt Lake City
International Airport



8.4 mi

UPS Store



7.8 mi

United States Postal
Service (USPS)

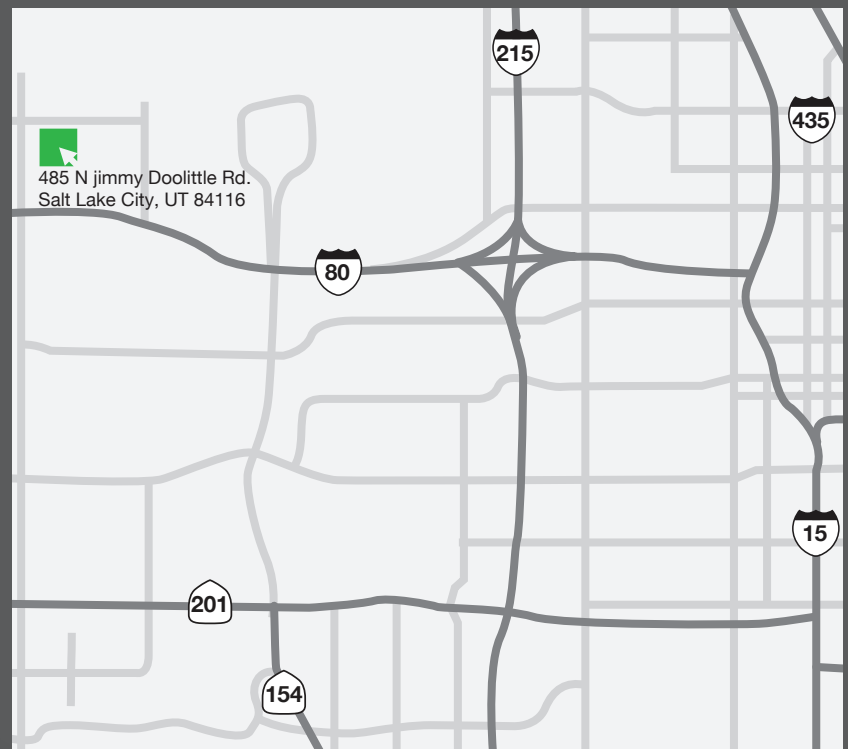

BUILDING FEATURES

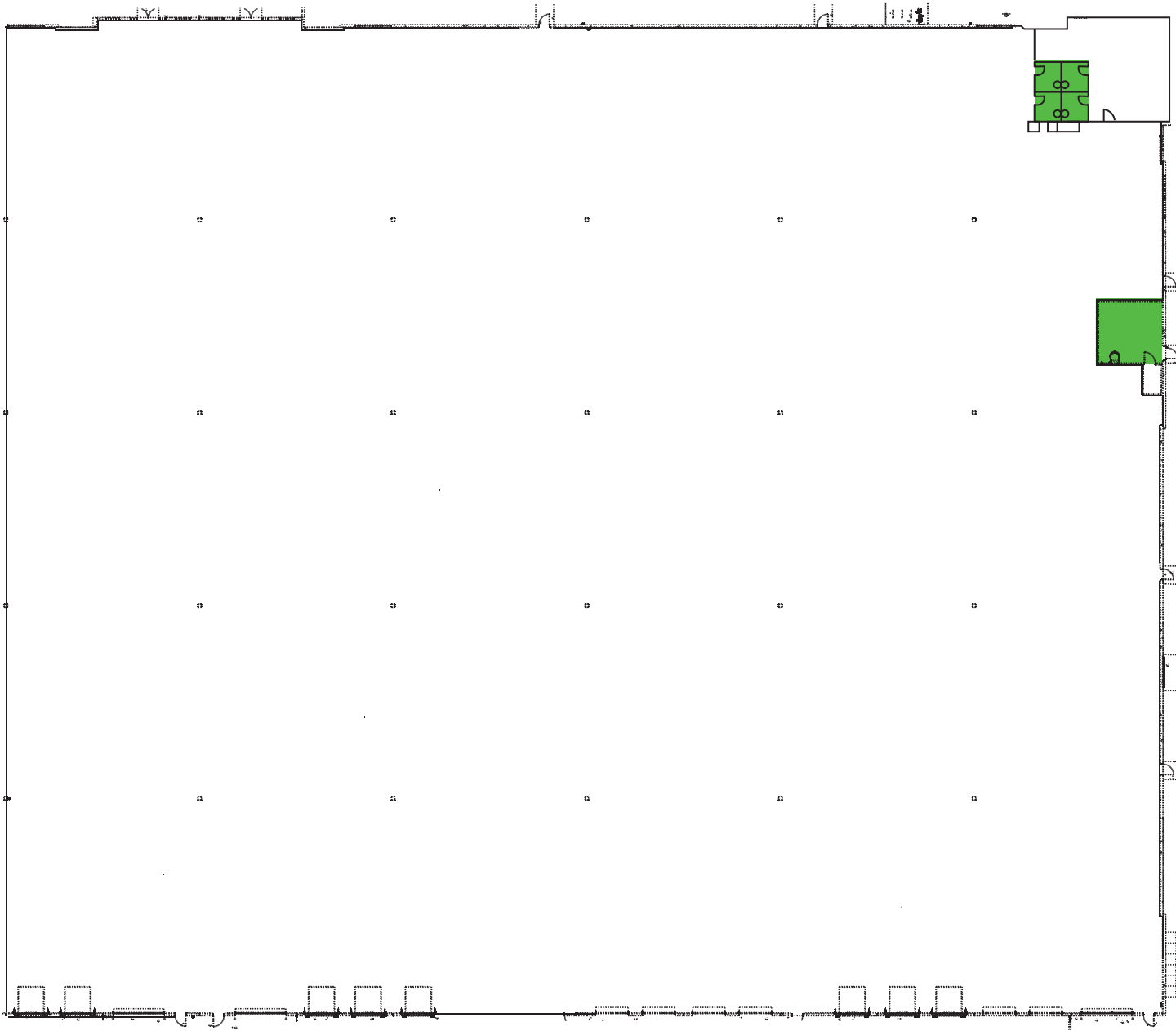



AMENITIES

- 24/7 Building Access
- High-Speed Internet
- Unique Common Areas
- Conference Rooms
- Coffee & Fresh Water
- Creative Workspaces
- 24/7 Customer Service
- Community Managers
- Mail and Package Handling
- Loading Docks
- CCTV, Surveillance System
- Daily Cleaning and Maintenance
- Business Class Printers
- Social Events
- Global Network
- Gym & Lockers
- Fully Furnished Offices
- Security Guards

SERVICES

- Front Desk Service
- Mail and Package Handling
- Daily Cleaning
- Office Supplies
- Business Class Printers
- Fresh Coffee & Tea
- Air Conditioning
- Surveillance
- Night Security Guards
- Flexible On-demand Warehouse Terms
- Option to Merge

FACILITY PHOTOS



FOR MORE INFORMATION CONTACT

 **(800) 338.6369**

 info@cubework.com

 www.cubework.com